



# Los Angeles Pierce College

## 2014 Facility Master Plan Update

July 9, 2014

Los Angeles Community College District  
Board of Trustees' Meeting





# Purpose of Facility Master Plan Update

- Maintain alignment with College Strategic Master Plan & Educational Master Plan.
- Optimize building utilization ratios and maximize student engagement.
- Balance planning with funding availability:
  - Reduce scope of Expanded Automotive & New Technical Education Facilities.
  - Reduce scope of Horticulture project\*.
  - Reduce scope of Digital Arts & Media and integrate more shared, general-use classrooms.
  - Absorb Green Technologies programs into existing classroom capacity.
- Planning through 2019.

*\*Name change, from Horticulture / Animal Science Lab to Horticulture Project*





# Reference Documents

Approved  
Master Plan

- **2011 Educational Master Plan (2012-2017)**

- Developed and implemented by the College
- Acted as guiding document for the development of:
  - Facility Strategic Plan
  - Technology Plan
  - Plan for Enrollment Management
- Approved by College: April 2012





# Reference Documents



- **Los Angeles Pierce College 2010 Master Plan Update (updated from 2002)**

- Reasons to update the Facility Master Plan
  - BOT rule 2605.1 / Admin Reg B-24 / Ed Code 70902
  - Update in response to Measure J opportunities
- Developed with Sasaki Associates, Inc. and implemented by the College
- Date Completed: 2010
- Approved by Board of Trustees: 2010
- CEQA Approval: August 25, 2010
- Planning through 2015



# Approved 2010 Facility Master Plan Update

Approved Master Plan

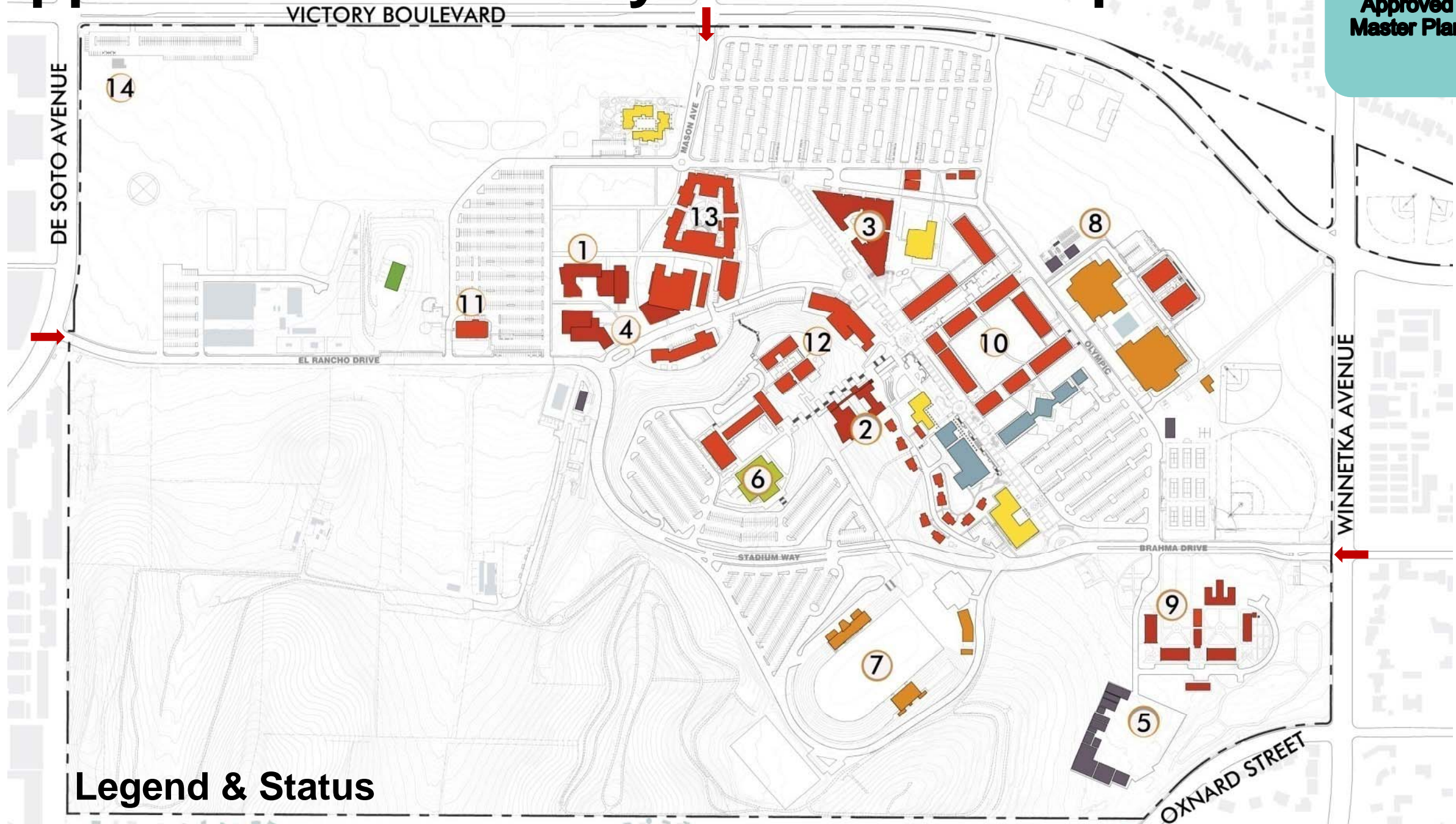

## Legend & Status

- |                                |   |   |
|--------------------------------|---|---|
| 1 Green Technology (unbuilt)   | 7 Stadium Upgrades (under renovation)               | 13 Ctr for Sci Renovation (compl. 2010) |
| 2 Digital Arts Media (unbuilt) | 8 Infrastructure, Central Plant Extension (unbuilt) | 14 Ag Ed Master Plan (unbuilt)          |
| 3 Library (complete 2013)      | 9 Horticulture Renovation/Expansion (unbuilt)       |   |
| 4 Auto / Tech (unbuilt)        | 10 North of Mall Renovation (under renovation)      |   |
| 5 M & O Facility (compl. 2012) | 11 Ag Sci Renovation (under renovation)             |   |
| 6 Perf Arts ADA (under reno.)  | 12 South of Mall Renovation (under renovation)      |   |



# Educational Master Plan Growth Factors

LONG TERM ENROLLMENT GROWTH

Growth  
Trend

Census Credit Headcount  
Fall 1947 - Fall 2013

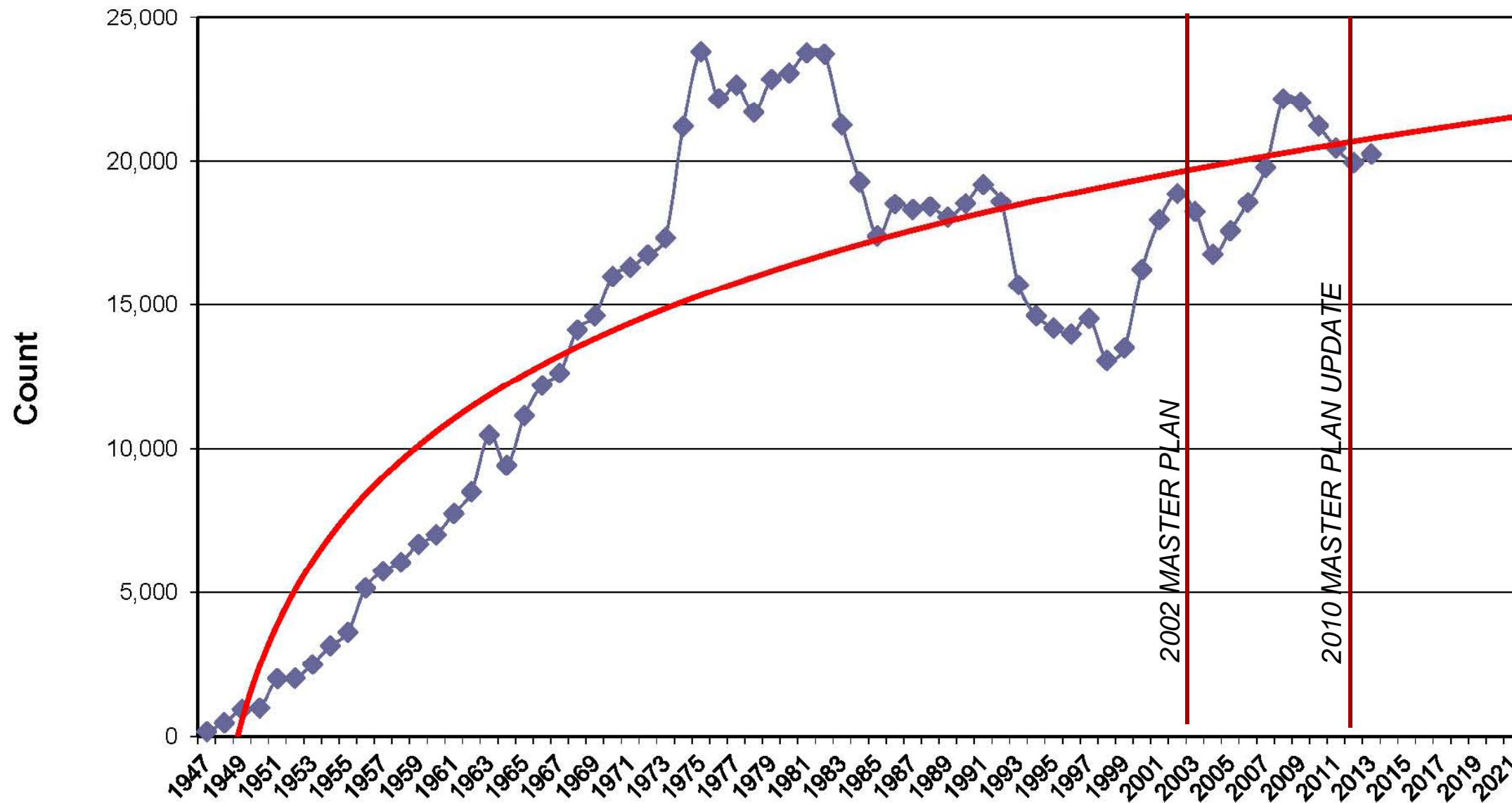

**Data Sources:** (CEN\_RDB): WSCH\_STUDENT, Enrollment Projections calculated by the Office of Institutional Effectiveness  
**Data Retrieved:** Annually following Census Date  
**Report compiled:** Kate Astor, Research Analyst; [AstorKH@piercecollege.edu](mailto:AstorKH@piercecollege.edu), x4493





# Educational Master Plan Growth Factors

PERFORMANCE AND COMPETITIVENESS

**Growth  
Trend**

## EFFICIENCY

	COLLEGE BASELINE	DISTRICT BASELINE
AVG CLASS SIZE IN CREDIT CLASS	42	40
COST FTES (ANNUAL)	\$3946	\$4149

## TEACHING / LEARNING FOR SUCCESS

	COLLEGE BASELINE	DISTRICT BASELINE	3 YEAR CHANGE	
			COLLEGE	DISTRICT
% NEW STUDENT COHORT COMPLETING 30 UNITS / 3 YEARS	68%	61%	2%	3%
% NEW STUDENT COHORT COMPLETING 60 UNITS / 3 YEARS	34%	28%	4%	-2%

## ACCESS / PREPARATION FOR SUCCESS

	COLLEGE BASELINE	DISTRICT BASELINE	3 YEAR CHANGE	
			COLLEGE	DISTRICT
PERSISTENCE: FALL TO SPRING	90%	87%	4%	2%
PERSISTENCE: FALL TO FALL	79%	75%	4%	4%



# Educational Master Plan Growth Factors

*SURROUNDING HIGH SCHOOLS SUCCESS RATE*

**Growth  
Trend**

High Schools	2011-12 Graduates	% Meeting CSU/UC Reqmts	2011-12 CA HS Lang Arts Exam Pass Rate	2011-12 HS Math Exam Pass Rate
Principal Contributing High Schools	5944*	<b>44% *</b>		
LAUSD	5247**		<b>86% **</b>	<b>89% **</b>
LA Total	37,532	37%	76%	77%
CA	104,785	40%	81%	82%
	418,598	38%	83%	84%

\*Includes El Camino Real

\*\*Does not include El Camino Real (partial data set)





# Geographic Areas Served by the Campus

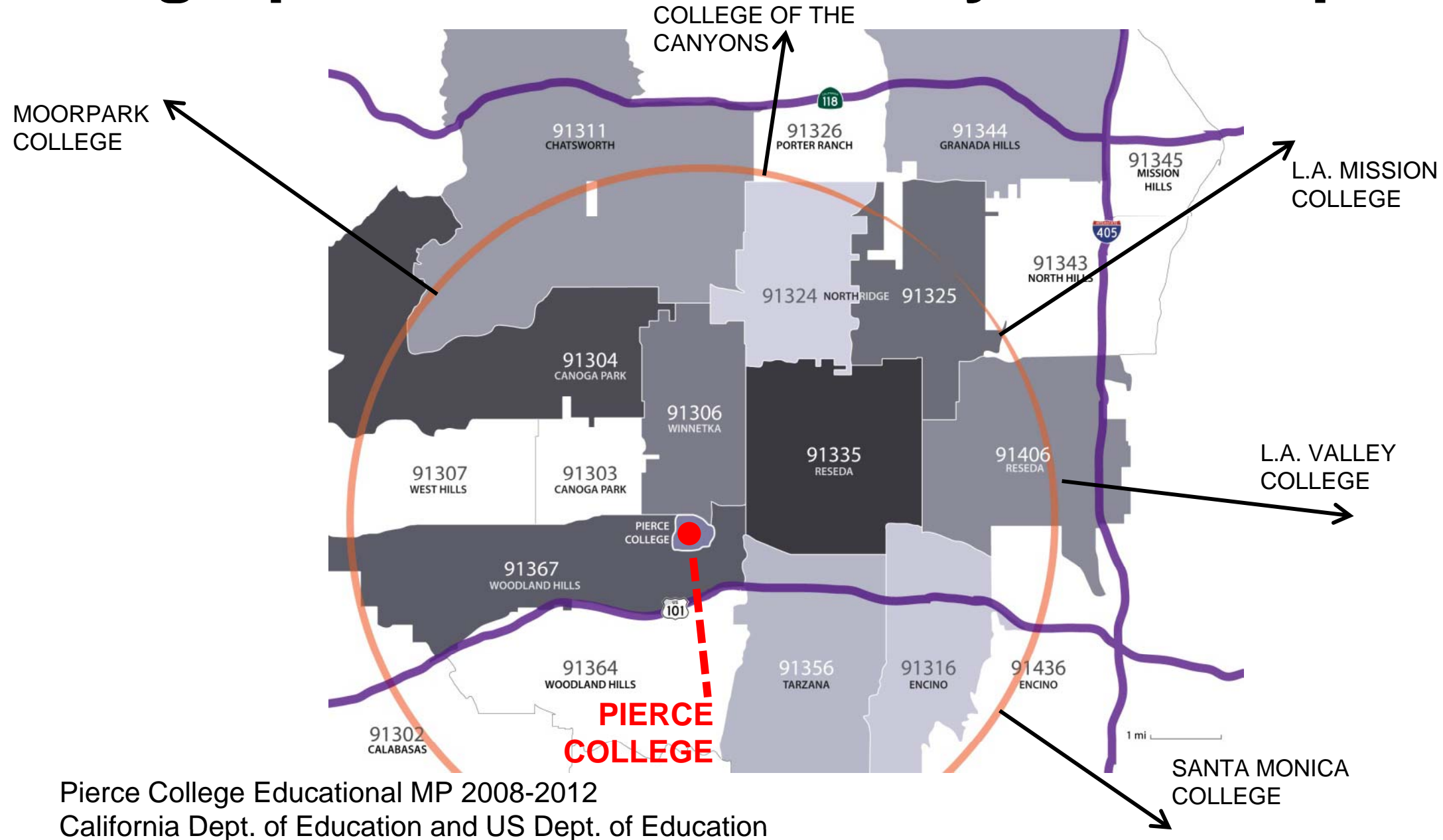

– Pierce College addresses Basic Skills, General Education, CTE, Stem, Transfer, and Noncredit needs of the San Fernando Valley, serving:

- |                   |                       |                     |                  |
|-------------------|-----------------------|---------------------|------------------|
| Business          | Automotive Technology | Computer Science/IT | Veterinary Care/ |
| Health Services   | Agriculture           | Performing Arts     | Animal Science   |
| Child Development | Arts/Media Arts       | Sciences            |                  |



# Priorities & Changes

Aligns with budget recovery plan

Prioritization  
&  
Changes

<u>Project Name</u>	<u>Total Budget</u>	<u>Scope</u>
<b>1 Horticulture</b>	\$7.8 million	Renovation
2 Campus Wide Infrastructure	\$5.5 million	Infrastructural Support
<b>3 Central Plant Extensions</b>	\$6.3 million	Infrastructural Support
<b>4 Expanded Automotive &amp; New Technical Education Facilities</b>	\$34.3 million	Lecture, Lab, Office and Infrastructure, Roadways
5 Various Space Improvements	\$2.2 million	Utilization Enhancements
6 South of Mall Classrooms	\$11.5 million	Lecture, Lab, Office
<b>7 Digital Arts &amp; Media</b>	\$37.9 million	Lecture, Lab, Office, Parking lots 4, 6 East
8 Campus Landscaping	\$5.9 million	Infrastructural Support
9 Agricultural Education Center	\$4.8 million	Pending Visioning
10 Village Road and Pierce Lane	\$2.8 million	Infrastructural Support
<b>Total</b>	<b>\$119 million</b>	

**Red indicates changes to the approved 2010 Master Plan Update**





# Priorities & Changes

Aligns with budget recovery plan

Prioritization  
&  
Changes

PROJECT	SF IN 2010 MASTER PLAN UPDATE	SF IN 2014 FACILITIES MASTER PLAN UPDATE
GREEN TECHNOLOGIES	70,000	0
EXPANDED AUTOMOTIVE & NEW TECHNICAL EDUCATION FACILITIES	20,000	20,000
DIGITAL ARTS & MEDIA	70,000	26,000
HORTICULTURE	15,451	2,000





# CEQA Conclusions

CEQA  
Conclusions

## Summary

Plan development reduced by 127,000 square feet, therefore no increase in student capacity from previous Facilities Master Plan.

## Historical Resources

Quonset Hut has been determined not to be an historical resource and mitigation measure HR-1 is not necessary.

## Traffic Mitigation

Traffic mitigation measure TR-1 at Winnetka / Victory is not necessary.



# Horticulture

Updates  
&  
Changes

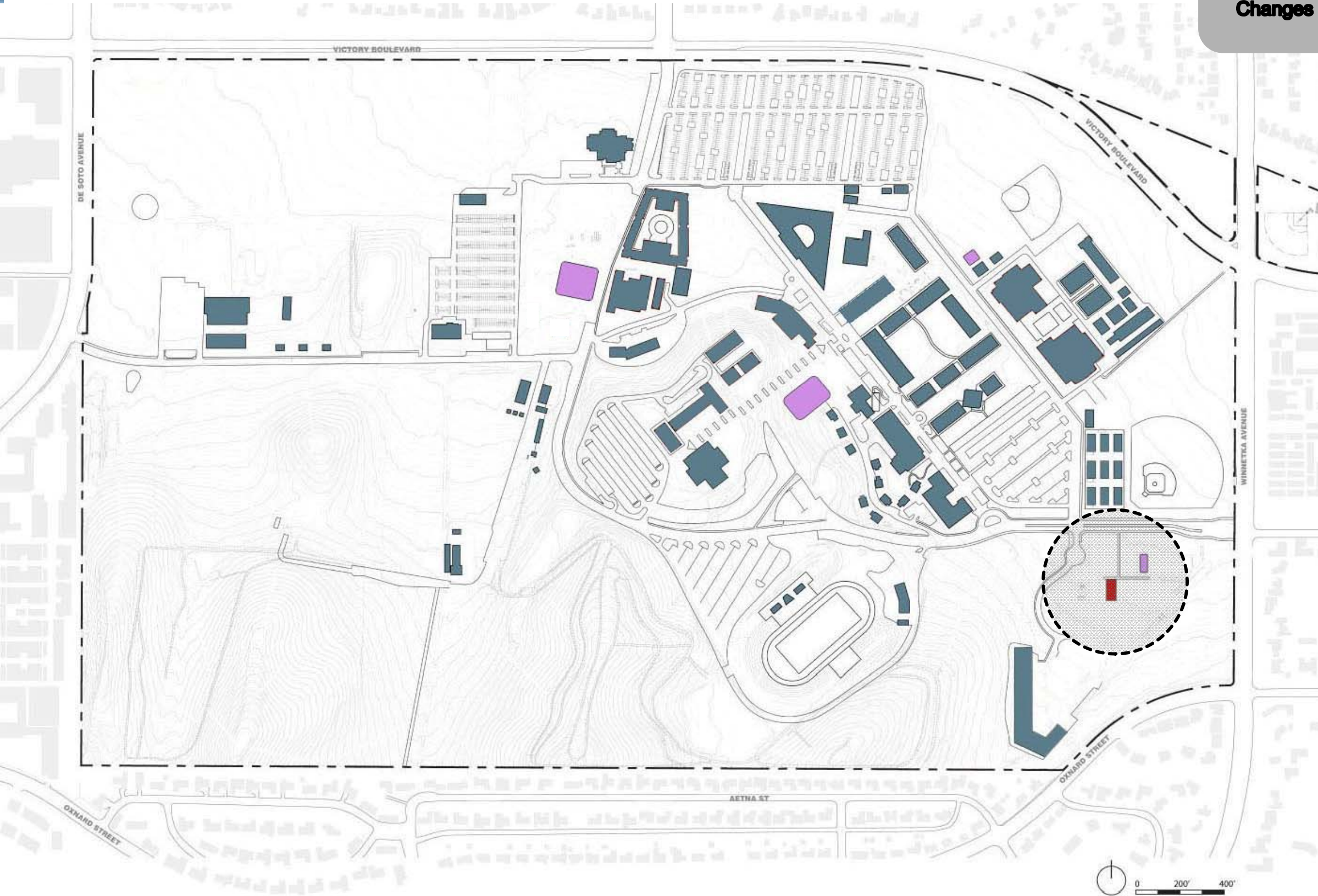

# Horticulture Detail

Updates  
&  
Changes

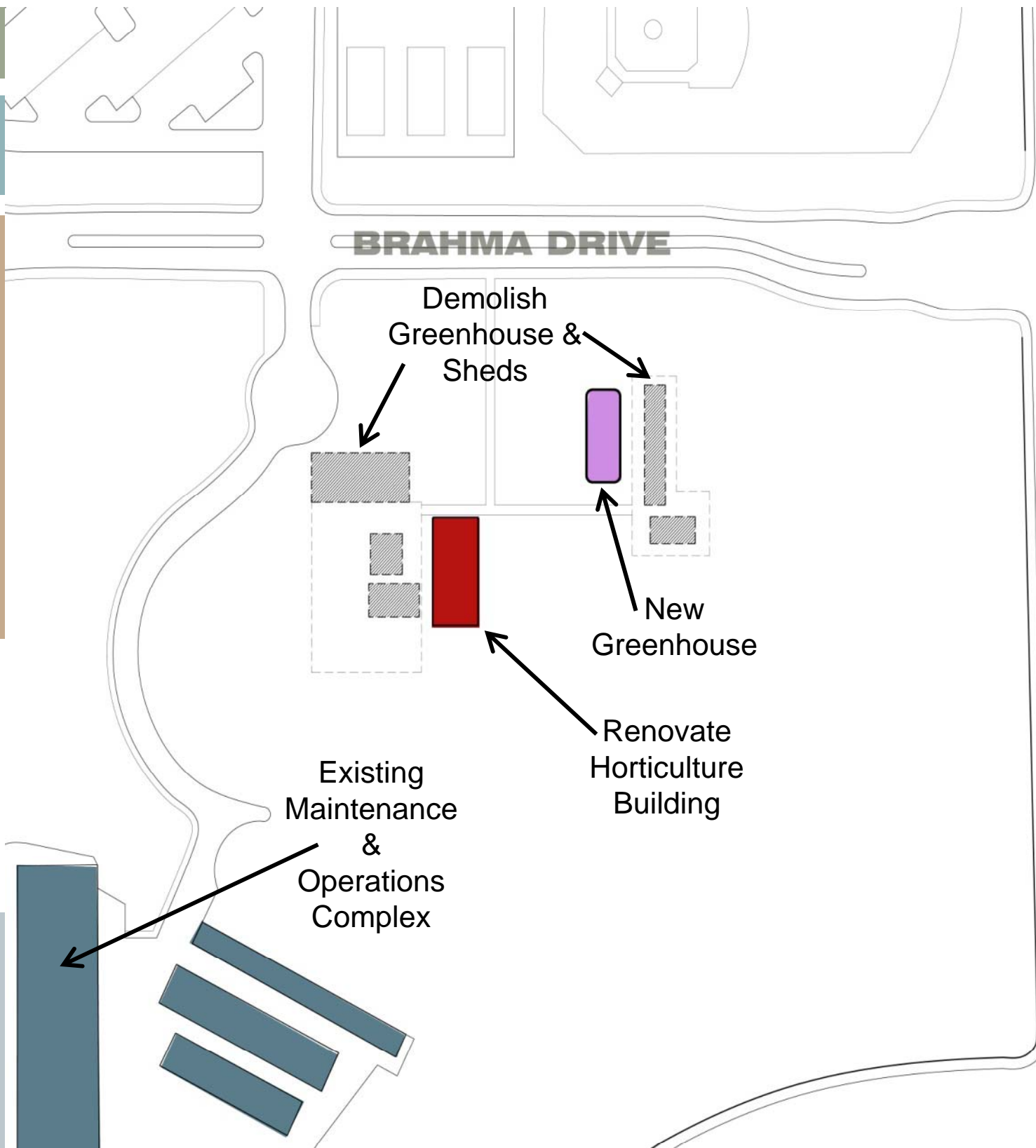

**HORTICULTURE**  
\$7.8 Million

- Demolish Existing Greenhouse & Utility Buildings
- Clean site
- Renovate Horticulture Building
- Construct new Greenhouse

	Existing
	Demolition
	Renovation
	New Construction



# Central Plant Extensions

Updates  
&  
Changes

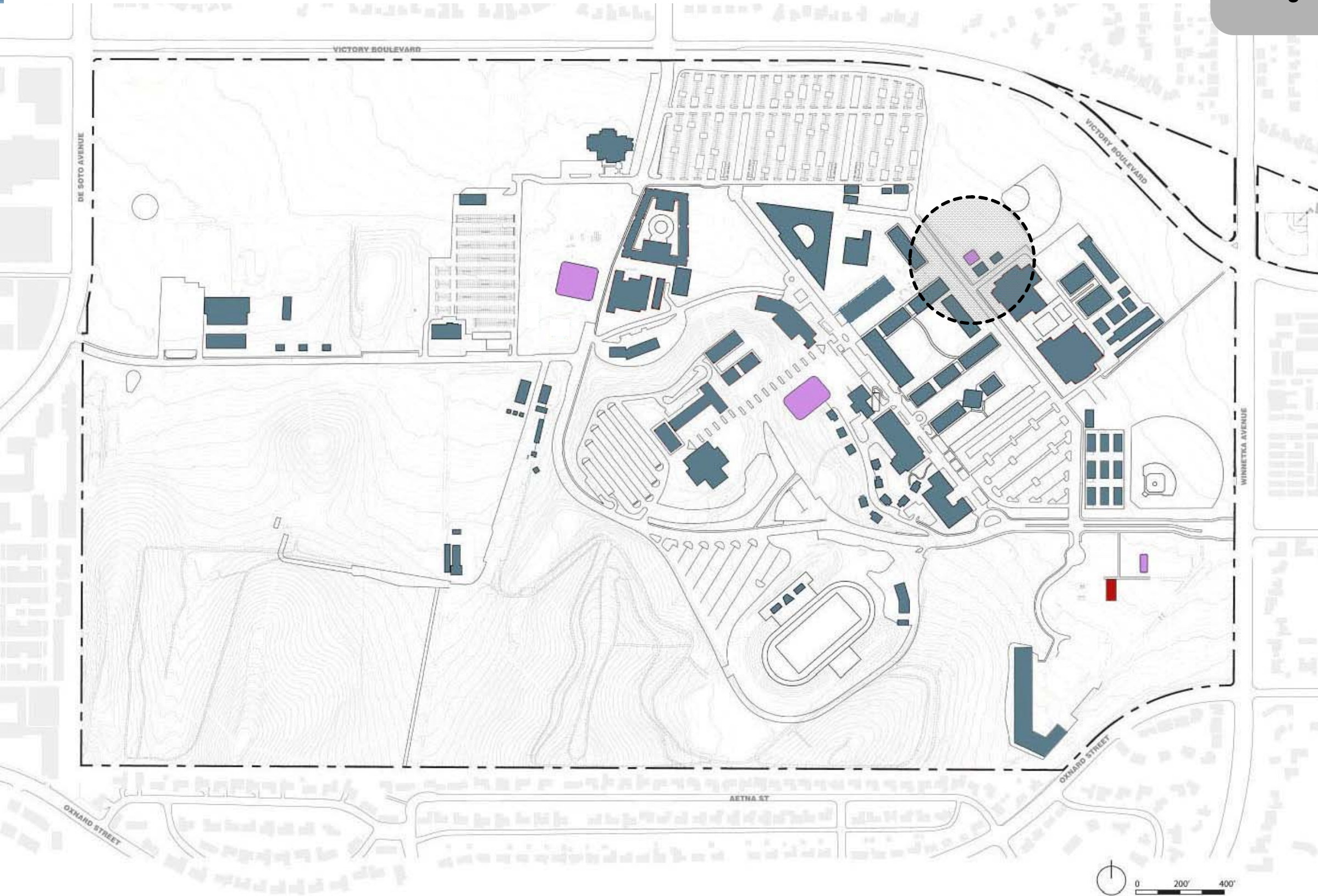

# Central Plant Extensions Detail

Updates  
&  
Changes

## CENTRAL PLANT EXTENSIONS

*\$6.3 Million*

Expansion of Central Plant to service new Measure 'J' facilities.





# Expanded Automotive & New Technical Education Facilities

Updates  
&  
Changes

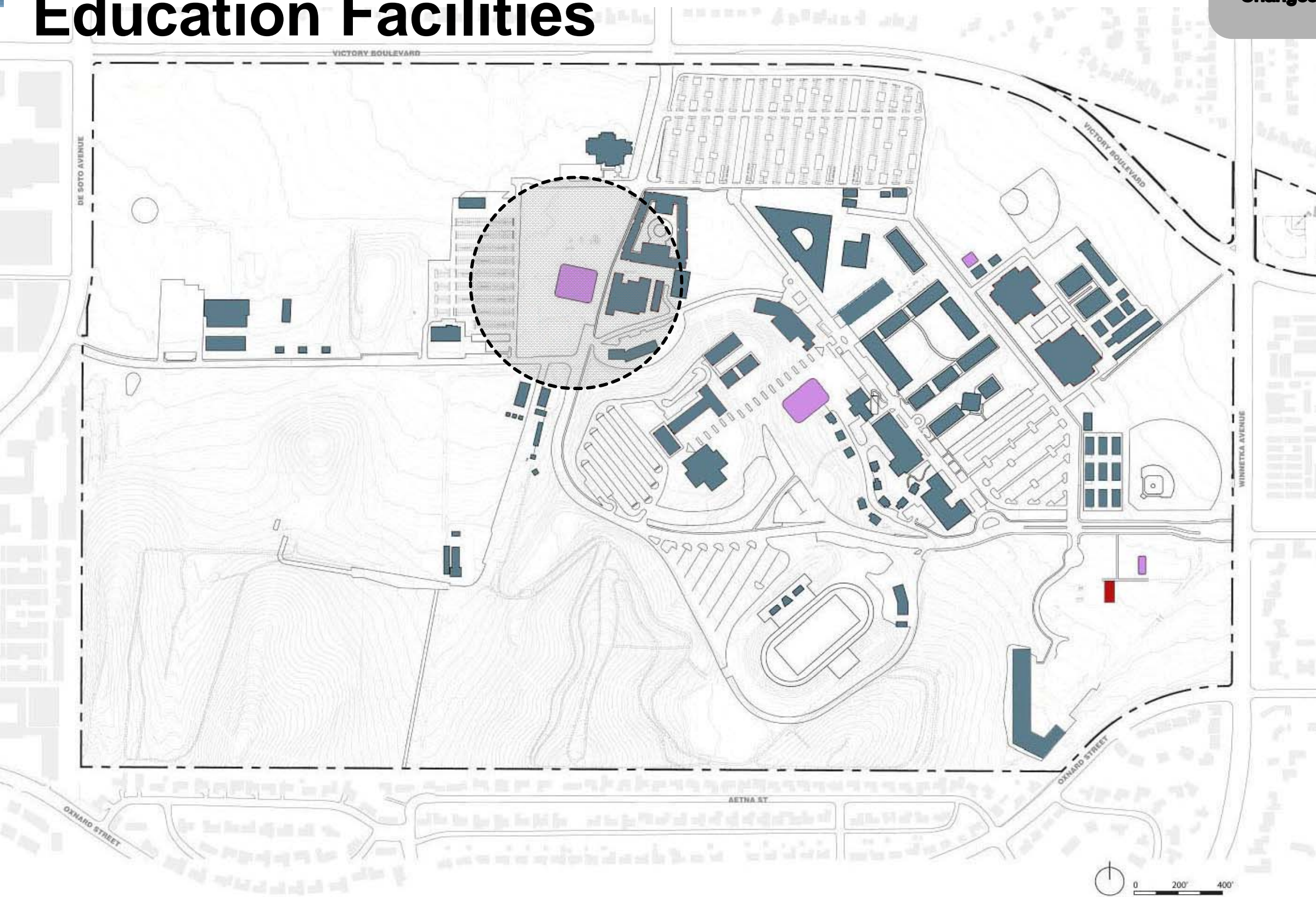

# Expanded Automotive & New Technical Education Facilities Detail

Updates  
&  
Changes

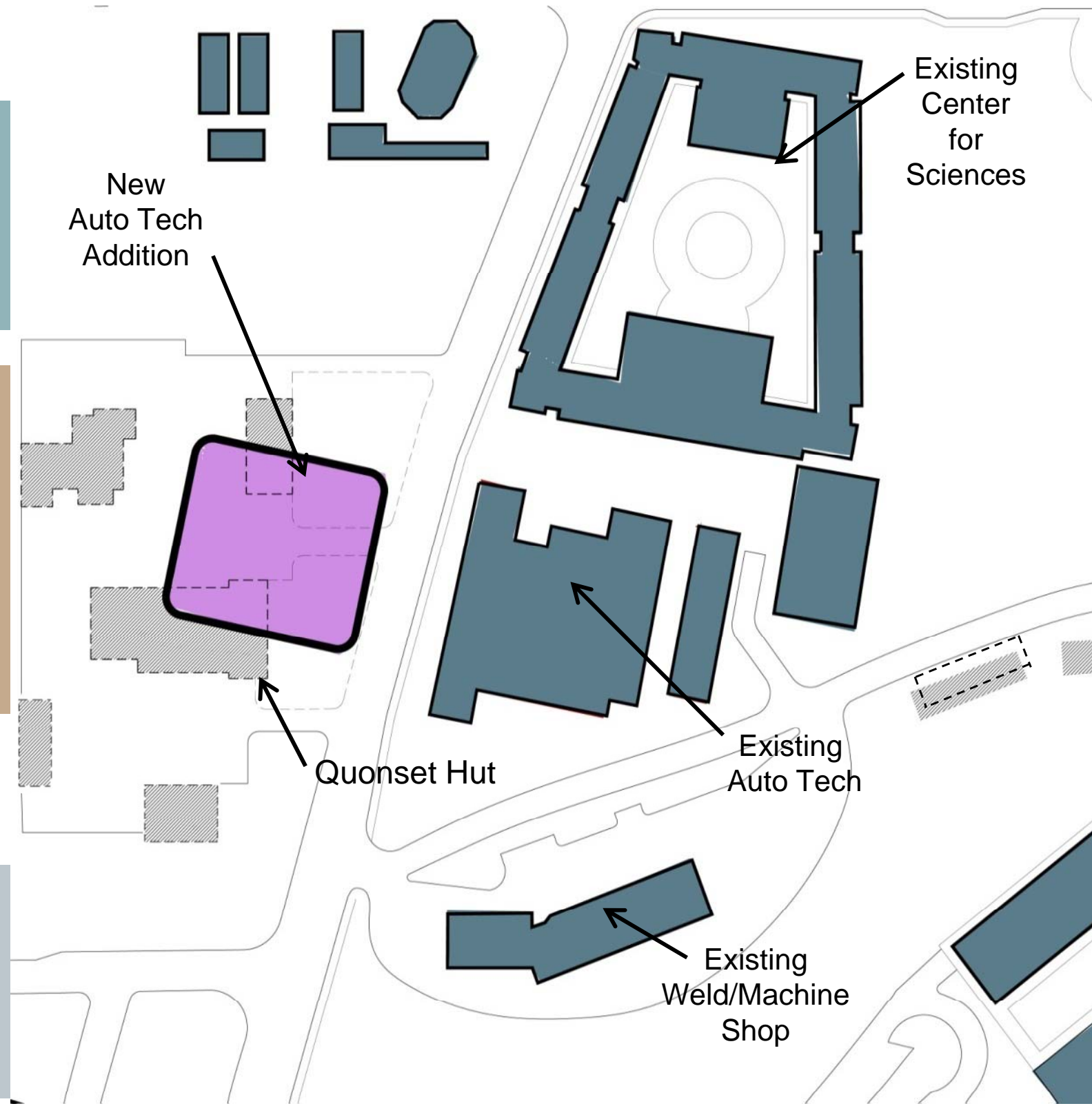

EXPANDED AUTOMOTIVE & NEW TECHNICAL EDUCATION FACILITIES

20,000 SF New  
\$34.3 Million

Demolish Utility Buildings  
Construct Automotive & New Technical Education Facilities  
Roadway Re-routing

- Existing
- Demolition
- Renovation
- New Construction



# Digital Arts & Media

Updates  
&  
Changes

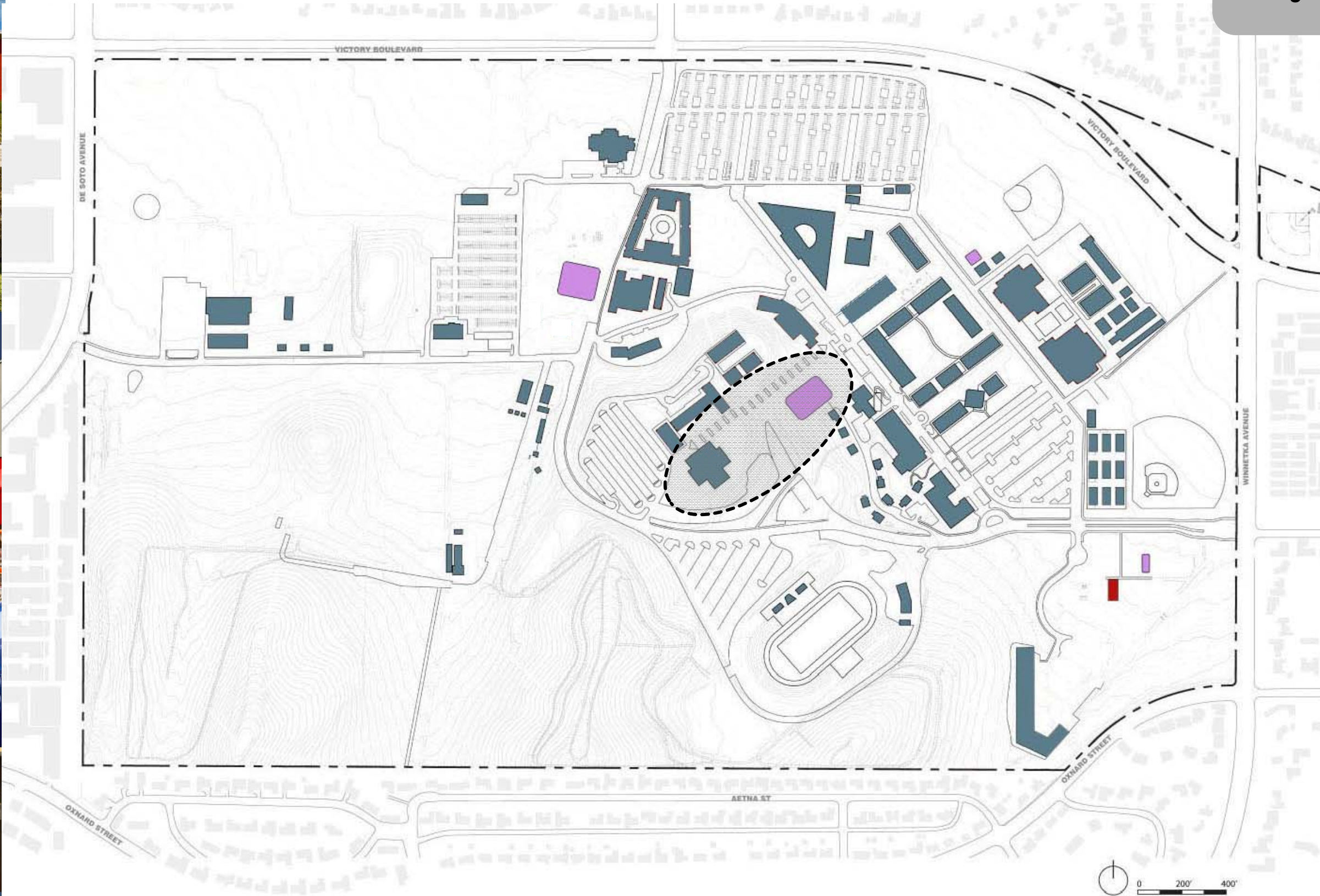

# Digital Arts & Media Detail

Updates  
&  
Changes



## DIGITAL ARTS & MEDIA

28,000 SF New  
\$37.9 Million

Demolish Existing Library

New Digital Arts & Media Building

New ADA Access Linking Campus North/South

Improve Parking Lots 4 & 6 East

- Existing
- Demolition
- New Construction
- Site Work



# Existing Built Conditions

EXISTING  
CONTEXT

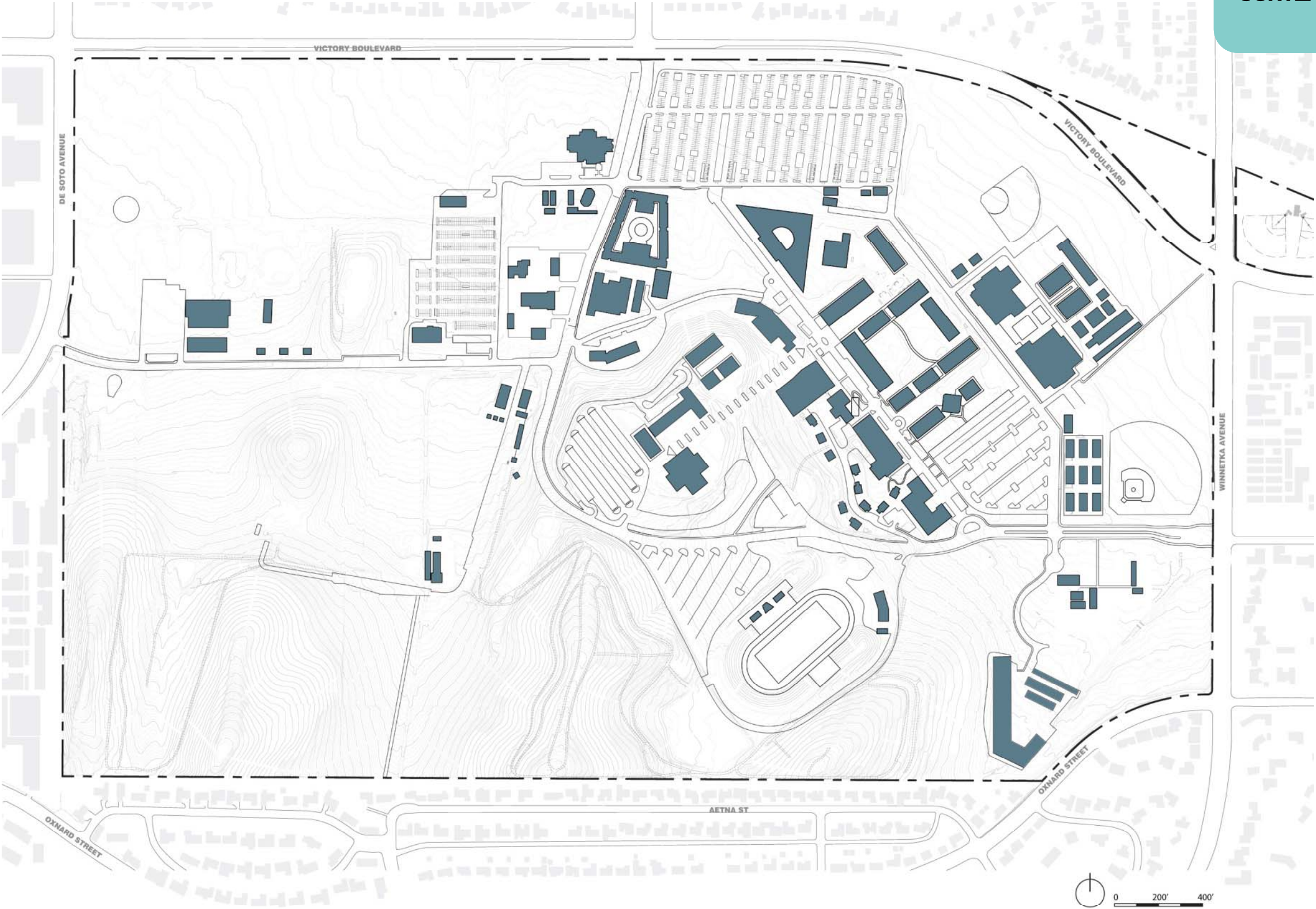

# 2014 Facility Master Plan Update / Changes

MASTER  
PLAN  
UPDATE /  
CHANGES

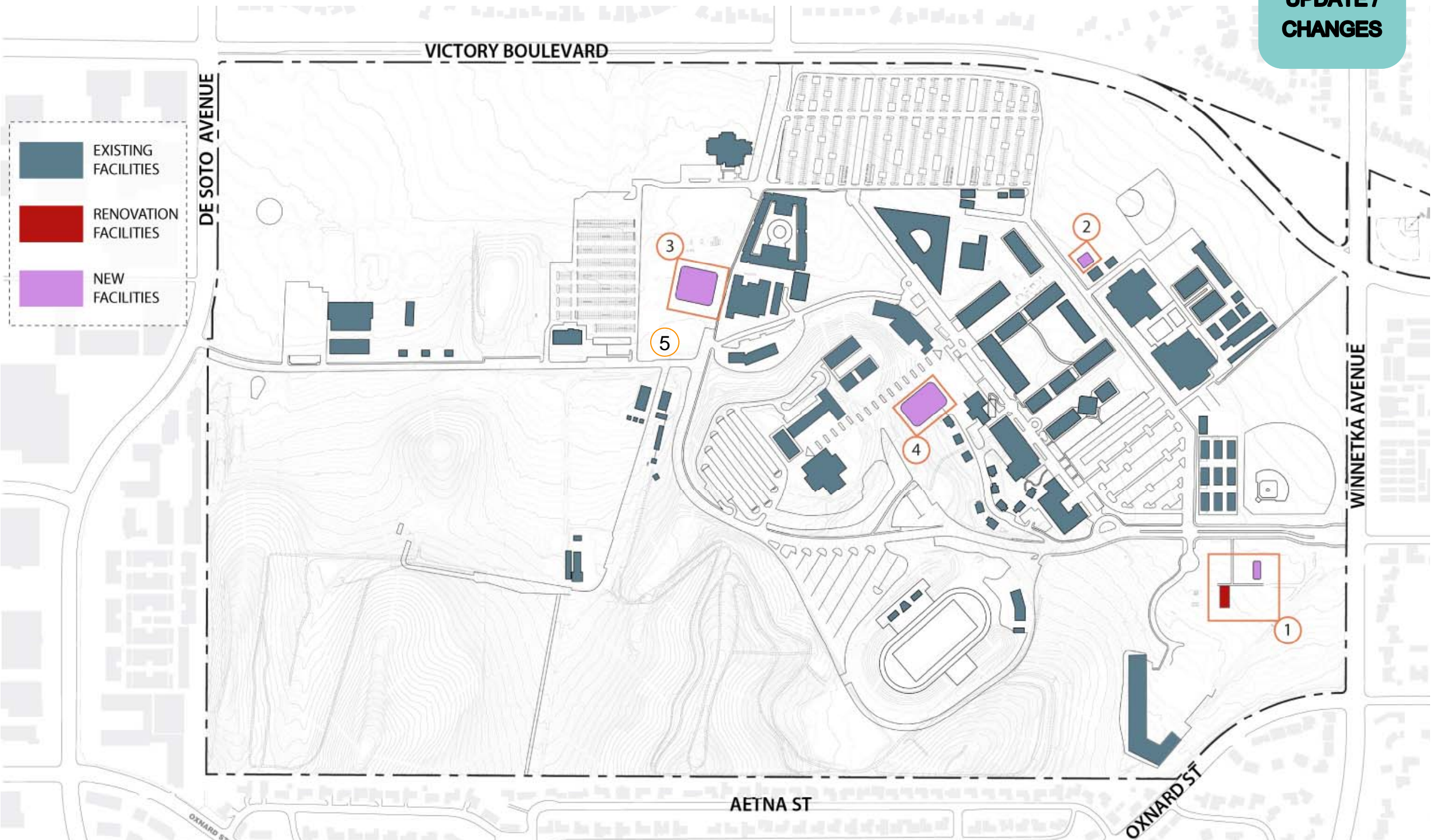

- 1 Horticulture    2 Central Plant Extensions    3 Expanded Automotive & New Technical Education Facilities
- 4 Digital Arts & Media    5 Green Technologies Building Deleted from Plan (programs re-distributed )



# Campus Space Utilization-Cap Load Ratio

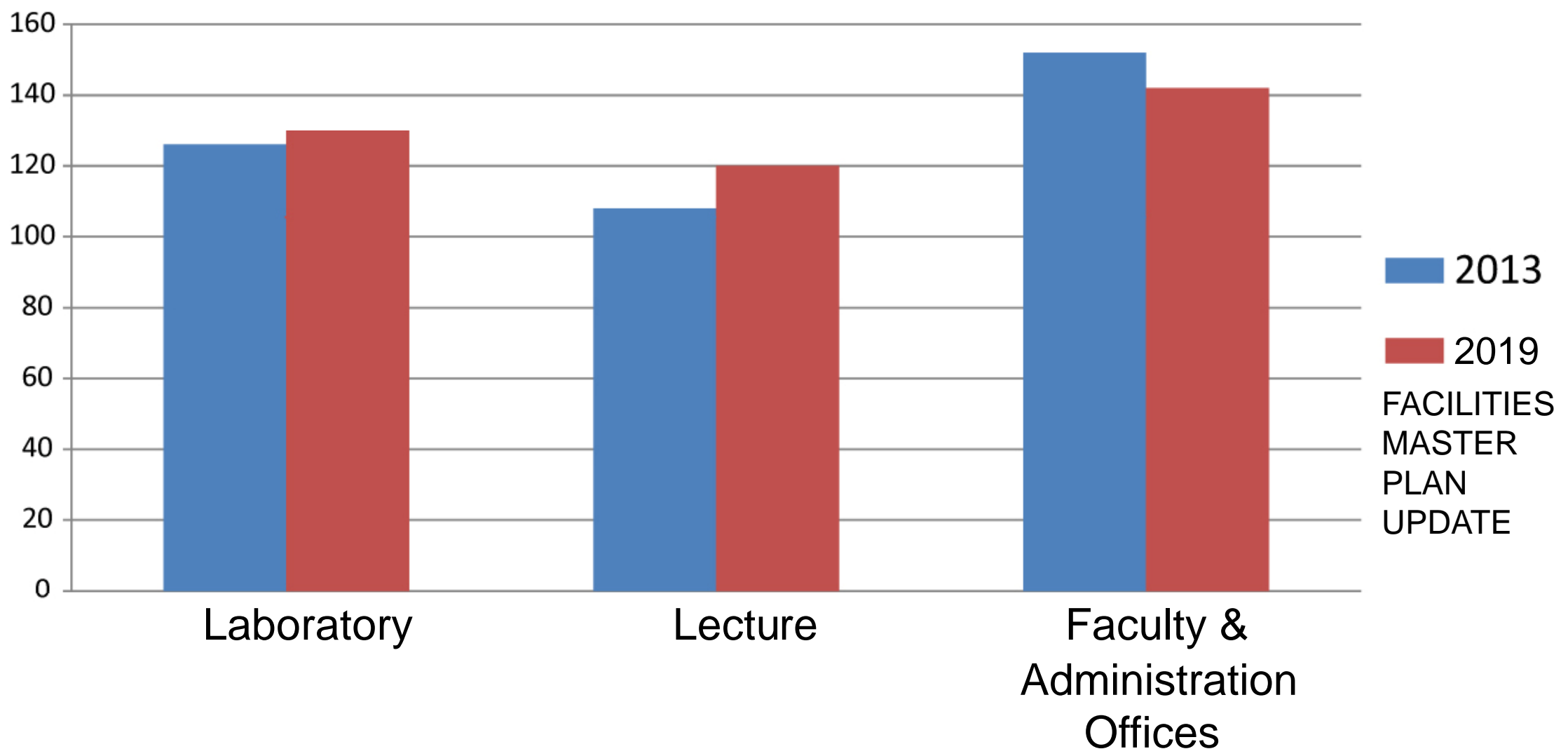

Reference:  
Fusion data as of  
January 2014





# Los Angeles Pierce College

## 2014 Facility Master Plan Update

July 9, 2014

Los Angeles Community College District  
Board of Trustees' Meeting



**BuildLACCD**  
*Building for tomorrow's leaders*

**PIERCE COLLEGE**